

## **Adjusting entrance door**

The two striker bolts which protrude from the door frame should be tight. I tighten them down, back off a quarter turn then make sure they move up and down. Once they are tight you should be able to grab either striker bolt and with some effort, the bolts, along with the back plate, should move up and down. If the bolts are too tight they will not 'float' and won't properly adjust and align with the door when closed.

It's also possible your handle and lock needs adjusting. Adjustments are performed by a nut on the rods that is turned to either lengthen or shorten the rod depending on the need. It could also be the latch mechanism itself; you might try lubricating this with white lithium grease.



### **Adjusting the Entry Door Latch:**

Determine which latch, top or bottom, needs adjustment. Slowly close each latch to the first position. Now pull the outside handle slowly to see if the two latches open at the same time. If they do not, or if the handle is at the fully pulled position, the latches need adjustment.

## Top Latch

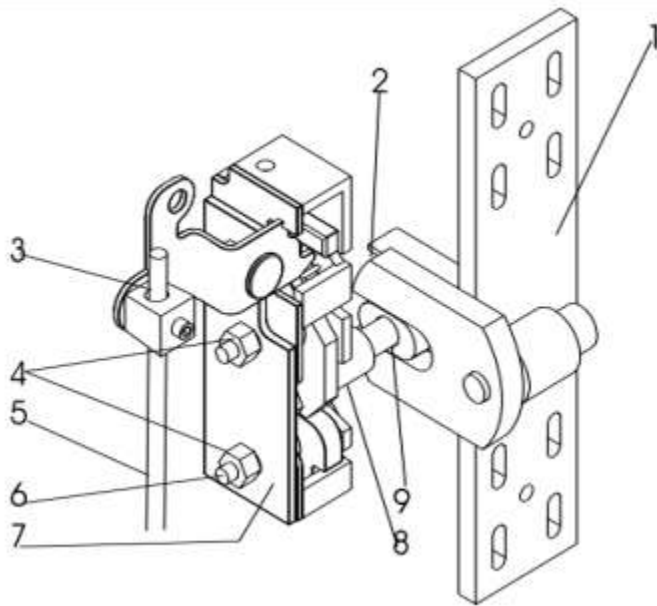

## Center Assembly

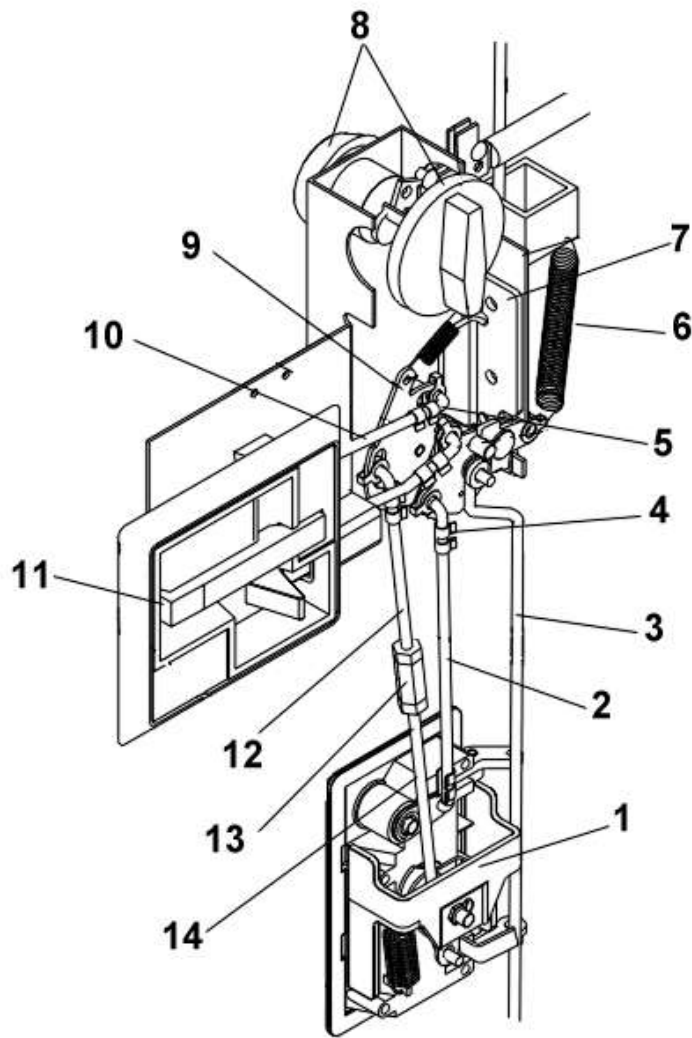

## Bottom Latch

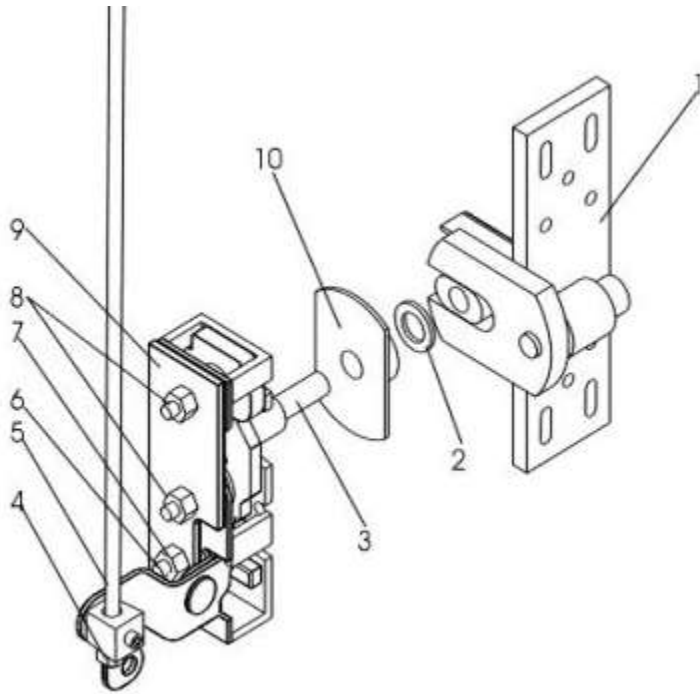

## CAUTION

When operating the entry door, ensure the dead bolt latch is fully unlocked prior to closing. Failure to do so can result in damage to the dead bolt and or entry door.

Note the top and bottom latch have a nut on the end of a long connecting rod. This nut is what is adjusted using a 7/16" open end wrench. You will not need to turn the nut much to reach adjustment. Whichever latch releases last is the one you need to adjust. Normally it is not necessary to adjust both top and bottom latches. You want the latches to release when the handle still has a little travel left.

Open the door and remove the end plate by removing 8 screws. Note there is a rubber gasket on the outer edge of the door and at the top and bottom corners of the end plate the gasket is cut at a 45-degree angle and then glued to a similar gasket along the top and bottom of the door. Use a sharp razor and cut the gasket along the 45-degree glue line, and remove the end plate.

Next remove all the screws in the places pictured here:

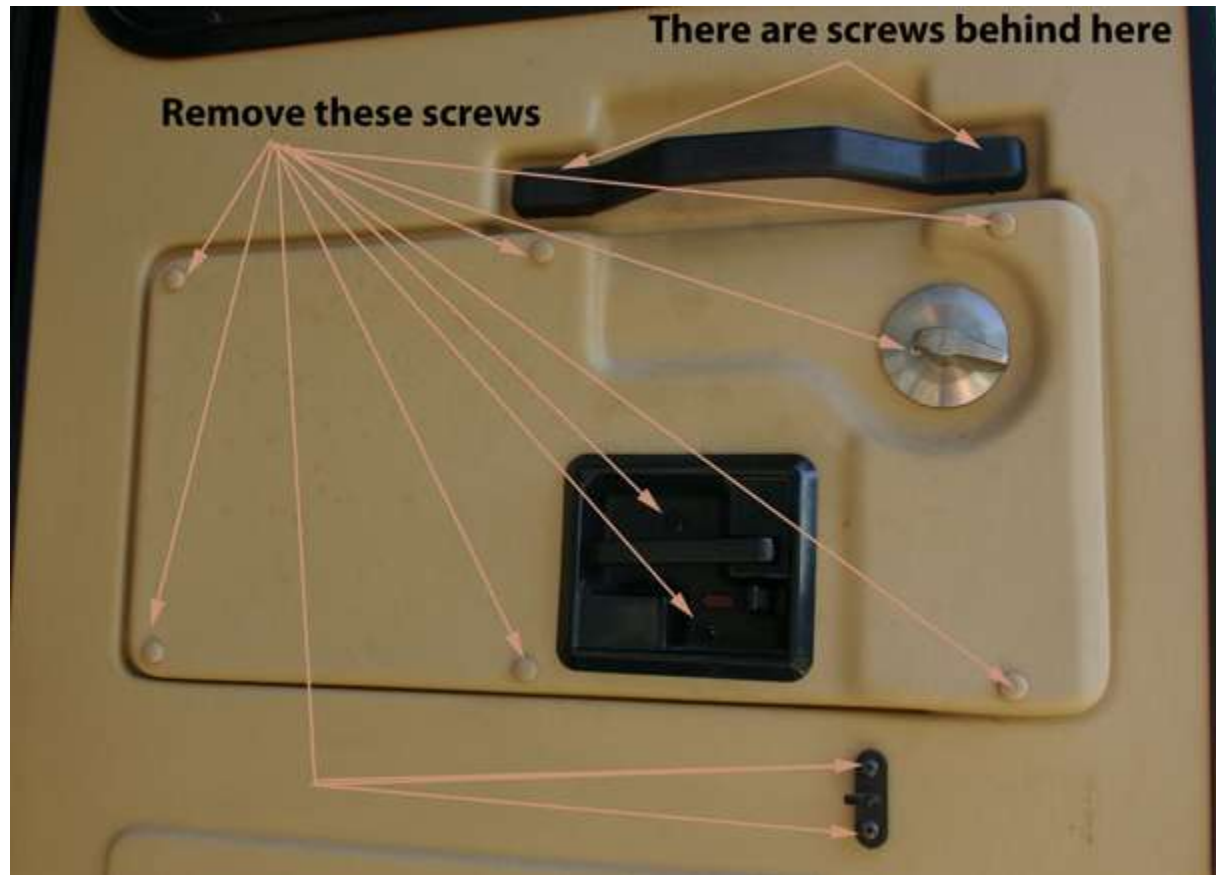

Use blue painters tape and put some on the outside window frame. Not all around it but enough to keep it from falling out. Now remove the screws on the inside frame, and the frame itself. Be careful not to push on the window with the screws out.

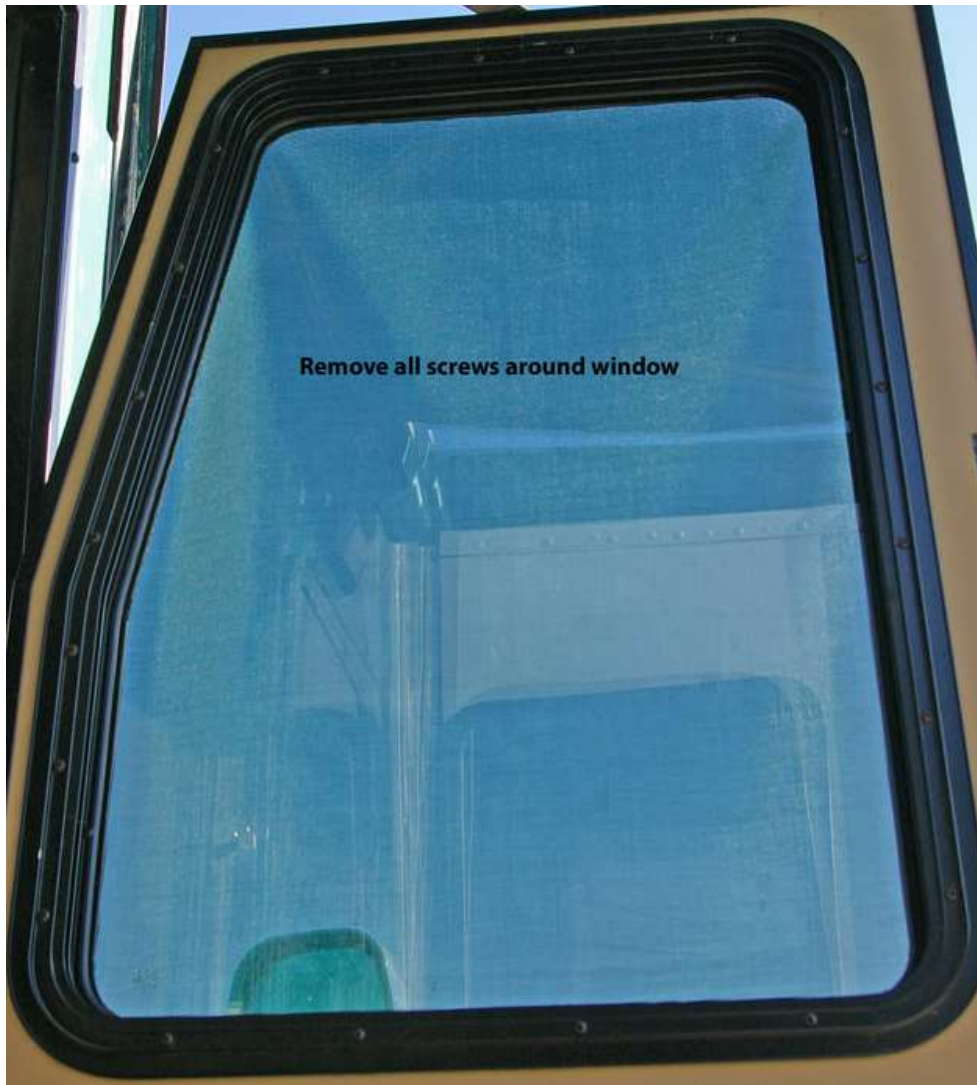

Now pull the interior panel back at the top and bottom latch assembly. There is a long rod that extends to each latch.

Determine which latch you need to adjust, and only adjust the nut at that latch. Tighten the 7/16" nut on the rod a turn or two, and check the latch timing.

Latch timing is both latches opening at the same time once you have closed them to the first position.

Continue adjusting till both latches release at the same time.

## Top Latch



## Bottom Latch





Now put it all back together. Use some contact cement on the gasket at the door corners to glue the gasket back together. You can put the contact cement on before you install the door end and let it dry till it is a bit tacky. Then put the end in place, install the screws, and now press the seal corners together tightly for a few seconds. The contact cement should hold the gasket together almost immediately.