

2003

Alpine Coach

AMERICA'S PREMIUM MOTOR COACH





2003



QUALITY AND COMFORT: IT'S A TRADITION!

Alpine Coach

Just like the strong foundation of our family owned business, Western Recreational Vehicles, Inc. has been building some of the toughest, most reliable Motor Coaches, Fifth-Wheels and Truck Campers for over three decades. We understand that tradition is the key to creating premium quality recreational vehicles year after year. We take pride in using state-of-the-art design and technology to build the luxurious Alpine Coach. Along with high quality and comfort, other top priorities include: safety, attention to detail, premium features and customer satisfaction.

Our Western RV family believes trust and experience go a long way. Our more than 31-year commitment to quality, comfort and reliability is a family tradition. So no matter where your journey takes you, trust our family to be there for your family.

1. Model 38 FDDS • Winter Wheat Interior with Booth Dinette option.
2. Solarcool mirror-tinted thermal pane windows increase privacy and insulation.
3. Model 40 FDTs • Kenmore® stacked Washer/Dryer with item shelf and Solid Cherry Cabinetry options.
4. 21.5 cu. ft. Amana® Residential Refrigerator option.
5. Model 40 MDTS • Rear cap with automotive style integrated tail lights, rear hidden backup camera and Meadow Green Premium Exterior.
6. Model 40 FDTs • Galley with Atwood® 22" Gas Oven and Walnut Stain Cabinetry options.

COVER PHOTO: MODEL 40 FDTs • Summer Bronze Premium Exterior with A&E One Step® Power Awning and Cummins® 8.9 ISL Electronic 400hp Engine options.







LIVE AND DRIVE IN FIRST-CLASS COMFORT.

MODEL 40 FDTs • Brandywine Interior with Solid Cherry Cabinetry, Atwood® 22" Gas Oven, Ultra-Leather Buddy Seat with Power Footrest and Flexsteel® Ultra-Leather Recliner options.



Even before you sit behind the wheel of an Alpine Coach, it's easy to see the first-class comfort and style. With each year Western Recreational Vehicles, Inc. surpasses even our own high expectations of excellence. We take pride in building America's premium recreational vehicles.

When you travel in a 2003 Alpine Coach, it's like taking all the luxuries and comforts of home along. The Coach offers a variety of first-class features, including spacious rooms, oversized windows, generous headroom, handcrafted hardwood cabinetry finished with residential hardware and much more. So no matter where your adventures lead, you'll be driving in first-class comfort in an *Alpine Coach.*



2003





New for 2003! Easy reading white background and backlit gauges with classic wood grain dash and steering wheel insets. Shown with standard Smart Wheel®.

With each new Alpine Coach, we take the time to design and build it with care and ingenuity. From the elegant Flexsteel® premium grade furniture to plush Carriage® residential grade carpeting, the Coach's interior design shows off your own personal fashion and flair.

The Alpine Coach has been named in national publications as the motorhome "that drives like a european sports sedan," is "...one fine driving machine" and "...it looks and feels like it should cost even more..." See for yourself what everyone is talking about and head to your local dealer for a test drive. Take a trip around the block and you'll want to take a trip across the country.

Pull-out dash drawer with cup holders and coach body function switches for an uncluttered cockpit.



Extra-wide and comfortable Ultra-Leather Buddy Seat with Power Footrest option.

A valuable feature for 2003 is the push button electronically operated recessed stepwell cover. When the step isn't needed, it's out of sight.

(Front door models only)



REST COMFORTABLY IN AN *Alpine Coach*.



MODEL 40 FDTS • Winter Wheat Interior with Solid Cherry Cabinetry option.

The comforts of home don't stop in the living room or galley; our engineers have designed unique sleeping and bathroom areas with you in mind. You're sure to sleep comfortably in the spacious master suite, equipped with a full 60" x 80" queen-size, or in our 40 FDTS floor plan, a full 76" x 80" king-size Discovery by Bodyrest® deluxe inner spring mattress designed for standard fitted sheets. The convenient cedar-lined wardrobe combined with drawers offer an abundant amount of space for your personal items. You'll always travel and rest comfortably in an *Alpine Coach*.



2003



Alpine Coach owners have always appreciated the custom design and elegance the spacious bath area has to offer. It features a fully enclosed shower, quality Moen® residential plumbing fixtures, a large insulated skylight and a one-piece Karadon® solid surface sink and vanity polished to an appealing high lustre.



New for 2003! Karadon® Solid Surface Polished Sink and Vanity.



Folding Shower Seat option for personal comfort.

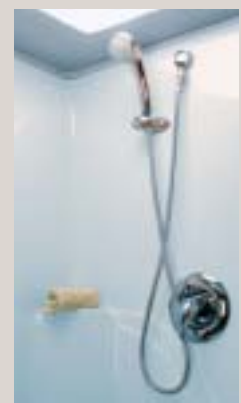

(std. white color shown)

Quality Moen® shower hardware and insulated skylight. New for 2003 is an optional textured granule shower or tub/shower combination matching the bath vanity color.

THE BEAUTY OF THE *Alpine Coach* SPEAKS FOR ITSELF.



EXTERIOR FEATURES

While the Alpine Coach's interior is exquisite, the exterior is just as magnificent, both in appearance and durability. The exterior is built to last and endure any type of weather. All new for 2003 are five Premium Exterior Color Groups in a striking transitional design as a standard feature.



The retractable fueling compartment is designed to eliminate the impact of accidental overfills and provide security for your fuel system. Also built into this handy area is a serviceable 7.5 kw Onan® Quiet Diesel generator.

MODEL 38 FDDS • Autumn Tan Premium Exterior with Winegard® Satellite Dish and Cummins® 8.9 ISL Electronic 400hp Engine options.



2003

MODEL 38 FDDS • Shadow Ebony Premium Exterior with A&E One Step® Power Awning, Winegard® Satellite Dish and Cummins® 8.9 ISL Electronic 400hp Engine options.



Pass through storage bays are spacious and equipped to handle all of your necessities.



Alpine's sanitation station is packed with premium features; black tank flush, pressurized hot/cold faucet and showerhead, light, soap dispenser, towel rack and connections for 50 amp service, cable TV, city water and telephone.

PERFORMANCE AND PROTECTION.

When it comes to drivability, Alpine Coach will exceed your expectations with its own Peak Custom Chassis. Our philosophy is simple: Build a coach with handling characteristics reminiscent of a European touring sedan. From the oversized Toyo® tires that deliver supreme traction and braking, to the powerful 8.3 ISC and 8.9 liter ISL Electronic Cummins® diesel engines, every detail was examined to make the Alpine Coach the finest and safest Premium Coach in its class.

Please see your dealer or contact Western Recreational Vehicles for copies of recent product reviews of the Alpine Coach and its high performance Peak Custom Chassis.

Experience the perfect balance of quality, performance and convenience. It only takes one test drive to see why Alpine Coach is changing the standards by which others are measured.

1. The engine maintenance center allows access to check engine oil, transmission fluid level, service of air filter, fuel filter, auxiliary air coupler and automotive diagnostic link.
2. Every electrical connection is well labeled, coded and harnessed. The use of aircraft and automotive connectors make this system virtually fail-safe.
3. Choose either the standard 4 point air or optional automatic hydraulic leveling system from HWH®, the industry leader in leveling systems.
4. The cooling system for the Cummins® diesel engine earned high honors by passing the strict Cummins® Engine Company test #AEB 90.24 cooling, a critical consideration when purchasing a diesel pusher motor coach.

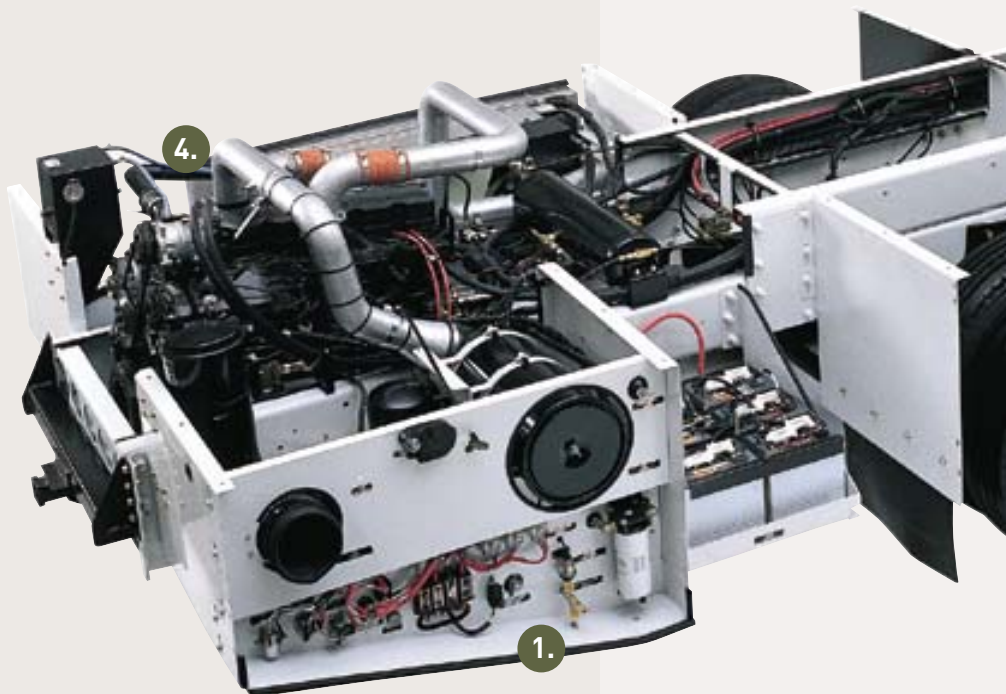

2003

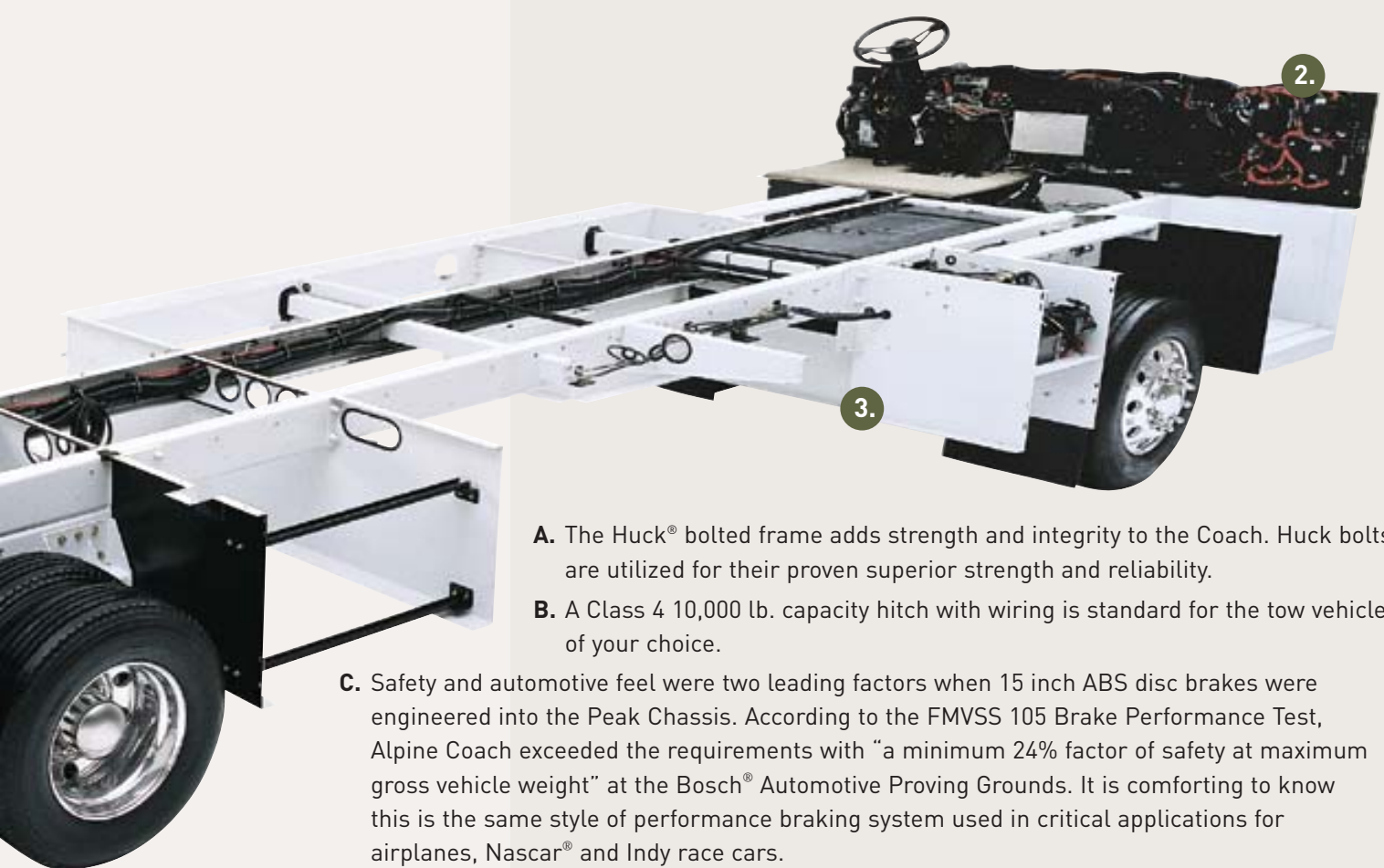

A. The Huck® bolted frame adds strength and integrity to the Coach. Huck bolts are utilized for their proven superior strength and reliability.

B. A Class 4 10,000 lb. capacity hitch with wiring is standard for the tow vehicle of your choice.

C. Safety and automotive feel were two leading factors when 15 inch ABS disc brakes were engineered into the Peak Chassis. According to the FMVSS 105 Brake Performance Test, Alpine Coach exceeded the requirements with "a minimum 24% factor of safety at maximum gross vehicle weight" at the Bosch® Automotive Proving Grounds. It is comforting to know this is the same style of performance braking system used in critical applications for airplanes, Nascar® and Indy race cars.

D. Peak Chassis features state-of-the-art wiring and vehicle electrical centers. For serviceability, all chassis wiring harnesses and cables are color and number coded from Leoni Cable Assemblies, Inc.®, an ISO 9000 company.

E. Two Group 31 Interstate® chassis batteries grouped together with four powerful Interstate® 6-volt house batteries provide maximum performance and extended usage.

F. Peak Chassis boasts one of the best handling air suspension systems. It includes a Neway® heavy-duty custom tuned air ride suspension, Bilstein® heavy-duty self-adjusting gas shocks, Toyo® high performance all steel radials, IPD 1 5/8" diameter front anti-sway bar and four ride height control valves to constantly monitor and react to changing road and weight conditions at each wheel. When you combine the above suspension systems with one of the best weight distributed coaches in the industry (40% front and 60% rear) you know you have invested in a great driving machine!



Alpine Coach SPECIFICATIONS

| PEAK CUSTOM CHASSIS | 34' | 36' | 38' | 40' |
|--|-----|-----|-----|-----|
| Cummins® 8.3 ISC 350 hp, 1,050 ft/lbs torque | s | s | s | s |
| Cummins® 8.9 ISL 400 hp, 1,200 ft/lbs torque w/Jacobs® Compression Brake | o | o | o | o |
| PAC® engine exhaust brake | s | s | s | s |
| Allison® 3000MH 6 speed World Transmission | s | s | s | s |
| Side mount cooling system, w/hydraulic self-modulating fan | s | s | s | s |
| Meritor® four wheel hydraulic four piston anti-lock disc brakes | s | s | s | s |
| Hub piloted, 22.5" x 8.25" polished aluminum wheels | s | s | s | s |
| Toyo® 295/75R 22.5" high performance radial tires | s | s | s | s |
| Neway® custom air ride suspension system w/12.5" front & 12.6" rear air bags | s | s | s | s |
| Bilstein® heavy-duty self adjusting gas shocks | s | s | s | s |
| HWH® 4 point computerized air leveling system | s | s | s | s |
| HWH® 4 point computerized hydraulic leveling system | o | o | o | o |
| Huck® bolted 50K psi high yield steel frame | s | s | s | s |
| Raised rail ladder style chassis | s | s | s | s |
| Class 4, 10,000 lb capacity towing hitch | s | s | s | s |
| Lighted chassis service center including: air cleaner, engine diagnostic plug, auxiliary air supply coupler, remote fuel filter, battery disconnect switch | s | s | s | s |
| Two Interstate® group 31 12-volt batteries | s | s | s | s |
| Leece-Neville® heavy-duty 160 amp alternator | s | s | s | s |
| Douglas Autotec® tilt & telescopic steering column | s | s | s | s |
| Thermal formed battery cover | s | s | s | s |
| Front & rear mud flaps | s | s | s | s |

| BODY CONSTRUCTION / EXTERIOR | 34' | 36' | 38' | 40' |
|---|-----|-----|-----|-----|
| Laminated/vacubonded 6005 T5 aluminum tube structure: 2" walls, 2.25" floor, 5.25" roof | s | s | s | s |
| One-piece fiberglass roof | s | s | s | s |
| Computer controlled urethane adhesive lamination process | s | s | s | s |
| 2 lb. density polystyrene block foam insulation, 34% higher "R"; value than fiberglass blanket | s | s | s | s |
| 45 degree mitered and MIG welded frame corners | s | s | s | s |
| Large living area slide-out | s | s | s | s |
| Bedroom wardrobe slide-out | s | s | s | n |
| Dual bedroom slide-out | n | n | n | s |
| Slide-out awnings | s | s | s | s |
| A&E One Step® fabric power awning w/weather shield | o | o | o | o |
| Solarcool mirror-tinted thermal pane windows | s | s | s | s |
| Kwikkee® single tier entrance step | s | s | s | s |
| HWH® self-synchronizing hydraulic main slide-out | s | s | s | s |
| Sealed/enclosed ceiling A/C duct w/interior Amoco® condensation barrier | s | s | s | s |
| PTL® lighted entry door w/screen | s | s | s | s |
| Insulated aluminum bay doors | s | s | s | s |
| Lighted & carpeted storage bays | s | s | s | s |
| Sanitation Station including: hot/cold outside sprayer/shower, paper towel holder, black tank flush system, light and soap dispenser | s | s | s | s |
| Premium Exterior/Interior Decor Choices: Arctic Blue/Mood Indigo (blue) Meadow Green/Sage Point (sage green) Meadow Green/Bermuda Teal (teal) Summer Bronze/Brandywine (spice) Shadow Ebony/Black Tie (black & khaki) Autumn Tan/Winter Wheat (natural/beige) | s | s | s | s |

| ENTERTAINMENT FEATURES | 34' | 36' | 38' | 40' |
|--------------------------|-----|-----|-----|-----|
| TV in living area | s | s | s | s |
| VCR, 4-head Hi-Fi stereo | s | s | s | s |
| Cable TV & phone hook up | s | s | s | s |

| ENTERTAINMENT FEATURES (CONTINUED) | 34' | 36' | 38' | 40' |
|--|-----|-----|-----|-----|
| Kenwood® AM/FM CD player w/5 point surround sound | s | s | s | s |
| 6 disc CD changer | s | s | s | s |
| Winegard® TV antenna w/signal amplifier | s | s | s | s |
| Winegard® Satellite dish (w/o receiver) | o | o | o | o |
| Motosat® electronic self-locating satellite dish and receiver | o | o | o | o |
| High quality shielded digital RG-6 coax cable | s | s | s | s |
| 20" TV in bedroom | s | s | s | s |
| Halogen reading lights w/dimmer switches | s | s | s | s |
| 110-volt bedroom reading lights w/dimmer switch | s | s | s | s |
| DVD player | s | s | s | s |

| BATH FEATURES | 34' | 36' | 38' | 40' |
|---|-----|-----|-----|-----|
| Moen® shower & bathroom fixtures | s | s | s | s |
| Large garden shower - white | s | s | s | s |
| Large garden shower - textured granule | o | o | o | o |
| Tub/shower combination - white | o | o | o | o |
| Tub/shower combination - textured granule | o | o | o | o |
| Cedar lined wardrobe closet | s | s | s | n |
| Insulated skylight | s | s | s | s |
| Private water closet w/Sealand® porcelain toilet | s | s | s | s |
| Karadon® solid surface polished vanity countertop | s | s | s | s |
| Suburban® 10 gallon DSI/110-volt water heater | s | s | s | s |
| Power roof vent w/remote switch (water closet) | s | s | s | s |
| Fan-tastic® Vent w/remote switch in bath hallway | s | s | s | s |
| Residential medicine cabinet w/high intensity light bar | s | s | s | s |
| WilsonArt® laminate wood floor | s | s | s | s |
| Folding shower seat | o | o | o | o |
| Majestic® Washer/Dryer combo | o | o | o | o |
| Kenmore® Washer/Dryer stacked | n | n | n | o |
| Remote 12-volt water pump start switch | s | s | s | s |

| INTERIOR COMFORTS | 34' | 36' | 38' | 40' |
|---|-----|-----|-----|-----|
| Hardwood cabinetry w/choice of natural or walnut stain | s | s | s | s |
| Solid cherry cabinetry | o | o | o | o |
| Residential grade cabinet hardware | s | s | s | s |
| Microlene® water filtration system | s | s | s | s |
| Aquajet® high volume marine water pump w/in-line filter | s | s | s | s |
| Moen® retractable galley faucet w/sprayer | s | s | s | s |
| Hardwood valance & blind at galley window | s | s | s | s |
| 110-volt fluorescent galley lighting | s | s | s | s |
| Karadon® solid surface countertops, sink filler & backsplash polished to a high lustre | s | s | s | s |
| Day/Night shades | s | s | s | s |
| Free standing hardwood dinette table w/2 chairs | s | s | s | s |
| Booth dinette | o | o♦ | o | o♦ |
| Folding dinette chairs (2) | o | o | o | o |
| Atwood® 3-burner cooktop | s | s | s | s |
| Atwood® 22" gas oven | o | o | o | o |
| Amana® 30" residential gas four-burner cooktop | o | o | n | o |
| Convection/microwave oven | s | s | s | s |
| Dometic® 10 cu.ft. refrigerator (stacked) w/pantry | s | s | s | s |
| Dometic® 12 cu.ft. refrigerator (side x side) w/o pantry | o | o | n | n |
| Dometic® 14 cu.ft. refrigerator (side x side) w/o pantry | n | n | o | o |
| 21.5 cu.ft. Amana® residential refrigerator w/mandatory auto-generator start system | n | n | o | o |
| Fan-Tastic® Vent in galley w/remote switch | s | s | s | s |
| Two-door pantry w/shelves | s | s | s | s |
| Power range vent hood w/light | s | s | s | s |
| WilsonArt® laminate wood flooring in galley | s | s | s | s |
| Residential wrap-around front privacy curtain | s | s | s | s |
| Carriage® residential grade carpet w/padding | s | s | s | s |



2003

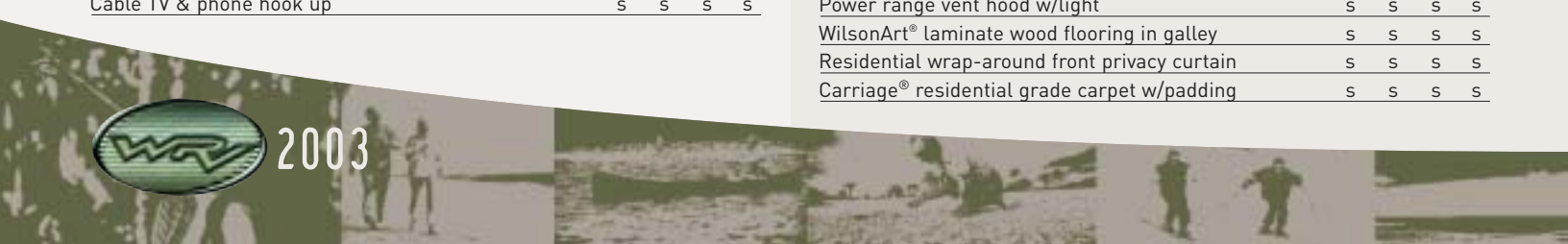

Alpine Coach SPECIFICATIONS (CONTINUED)

| INTERIOR COMFORTS (CONTINUED) | 34' | 36' | 38' | 40' |
|--|-----|-----|-----|-----|
| Dometic® two-zone dual 13,500 btu ducted A/C | s | s | s | s |
| Dometic® dual 15,000 btu ducted A/C w/integrated heat pumps | o | o | o | o |
| Ceramic tile throughout galley, dinette & bath | o | o | o | o |
| Large nickel plated stainless steel double galley sink | s | s | s | s |
| Hydro-Flame® 42,000 btu ducted LP furnace | s | s | s | s |
| Central vacuum cleaner w/attachments | s | s | s | s |
| Computer desk (curbside - N/A w/EZ bed) | n | o♦ | n | o♦ |
| Flexsteel® Premium upholstered recliner (curbside) | s | s | s | s |
| Flexsteel® Premium ultra-leather recliner (curbside - upgrade) | o | o | o | o |
| Flexsteel® Premium euro chair w/ottoman | o | o | o | o |
| Flexsteel® Premium upholstered EZ bed (roadside) | s | s | s | s |
| Flexsteel® Premium ultra-leather EZ bed (roadside) | o | o | o | o |
| Flexsteel® Premium upholstered EZ bed (curbside) | n | o♦ | o | o♦ |
| Flexsteel® Premium ultra-leather EZ bed (curbside) | n | o♦ | o | o♦ |
| Bodyrest® 60" x 80" full queen size walk around bed | s | s | s | s♦ |
| Bodyrest® 76" x 80" full king size walk around bed | n | n | n | s♦ |
| U-Line® icemaker in basement | o | o | o | o♦ |
| Premium Exterior/Interior Decor Choices: | s | s | s | s |
| Arctic Blue/Mood Indigo (blue) | | | | |
| Meadow Green/Sage Point (sage green) | | | | |
| Meadow Green/Bermuda Teal (teal) | | | | |
| Summer Bronze/Brandywine (spice) | | | | |
| Shadow Ebony/Black Tie (black & khaki) | | | | |
| Autumn Tan/Winter Wheat (natural/beige) | | | | |

| ELECTRICAL SYSTEMS | 34' | 36' | 38' | 40' |
|--|-----|-----|-----|-----|
| 7.5 kw Onan® quiet diesel generator | s | s | s | s |
| Interstate® batteries | s | s | s | s |
| 2000-watt Heart® inverter w/100 amp charger: | s | s | s | s |
| two group 31 12-volt batteries (chassis), four 105 amp hour 6-volt batteries (house) | | | | |
| Echo® battery monitor system w/overcharge protection | s | s | s | s |
| Siemens® solar panels - (2) 50-watt/3 amp | o | o | o | o |
| Solar panel - 10-watt trickle charge | o | o | o | o |
| 12-volt remote shut-off switch | s | s | s | s |
| 50 amp service w/detachable power cord - 35 ft. cable | s | s | s | s |

| ELECTRICAL SYSTEMS (CONTINUED) | 34' | 36' | 38' | 40' |
|--|-----|-----|-----|-----|
| High intensity patio awning light | s | s | s | s |
| 6-pin tow plug | s | s | s | s |
| Basement cable TV & telephone | s | s | s | s |
| Basement dual 110-volt GFI outlet | s | s | s | s |
| Glendinning® power cable reel - 35 ft. cable | o | o | o | o |
| Automatic generator start system | n | n | o† | o† |

| DRIVING COMFORTS | 34' | 36' | 38' | 40' |
|---|-----|-----|-----|-----|
| Ergonomically designed dash w/oversized gauges | s | s | s | s |
| Dual air horns | s | s | s | s |
| Electronic cruise control & throttle | s | s | s | s |
| Multi-plex dash instrumentation | s | s | s | s |
| Integrated drive-train monitor systems | s | s | s | s |
| Battery boost switch | s | s | s | s |
| Rear hidden camera & dash-mounted monitor | s | s | s | s |
| Bus style urethane set windshields | s | s | s | s |
| Articulating sun visors | s | s | s | s |
| Flexsteel® ultra-leather driver/passenger seats | s | s | s | s |
| 6-way power driver seat | s | s | s | s |
| Ultra-leather buddy seat w/power footrest (curbside) | o | o | o | o |
| Electrically operated recessed stepwell cover | s | s♦ | s | s♦ |
| Dual map lights | s | s | s | s |
| Dual auxiliary circulation fans | s | s | s | s |
| Hella® automotive style sealed beam halogen headlamps | s | s | s | s |
| Forward mounted chrome mirrors, heated & remote controlled | s | s | s | s |
| Leather-wrapped 18" steering wheel w/wood grain insets | s | s | s | s |
| Smart Wheel® w/momentary running light and headlamp buttons, cruise control & windshield wiper delay controls | s | s | s | s |
| Driving lights | s | s | s | s |
| Two remote generator start switches | s | s | s | s |
| Auxiliary 12-volt dash receptacle | s | s | s | s |
| CB antenna & coax pre-wire | s | s | s | s |
| Dash A/C & heating | s | s | s | s |
| Cabinet storage above driver and passenger | s | s | s | s |

Alpine Coach WEIGHTS AND MEASURES

| | 34FDDS | 36FDDS | 36MDDS | 38FDDS | 40FDDTS | 40MDDTS |
|---|--------|--------|--------|--------|---------|---------|
| Interior height | 6'7" | 6'7" | 6'7" | 6'7" | 6'7" | 6'7" |
| Exterior height | 11'9" | 11'9" | 11'9" | 11'9" | 11'9" | 11'9" |
| Exterior width | 102" | 102" | 102" | 102" | 102" | 102" |
| Wheelbase | 217" | 252" | 252" | 260" | 278" | 278" |
| Length overall | 34'11" | 37' | 37' | 38'6" | 40' | 40' |
| Gross Axle Weight Rating - GAWR front | 12,000 | 12,000 | 12,000 | 12,000 | 12,000 | 12,000 |
| Gross Axle Weight Rating - GAWR rear | 19,000 | 19,000 | 19,000 | 19,000 | 19,000 | 19,000 |
| Unloaded Vehicle Weight with fuel - UVW lbs | 23,495 | 23,863 | 23,820 | 24,224 | 25,411 | 25,647 |
| Cargo Carrying Capacity - CCC lbs | 5,787 | 5,419 | 5,462 | 5,058 | 3,871 | 3,635 |
| Gross Vehicle Weight Rating - GVWR lbs | 31,000 | 31,000 | 31,000 | 31,000 | 31,000 | 31,000 |
| Gross Combined Weight Rating - GCWR lbs* | 41,000 | 41,000 | 41,000 | 41,000 | 41,000 | 41,000 |
| Fuel tank - gallons | 97 | 97 | 97 | 97 | 97 | 97 |
| LPG tank - gallons | 42 | 42 | 42 | 42 | 42 | 42 |
| Fresh water - gallons | 100 | 100 | 100 | 100 | 100 | 100 |
| Grey water - gallons | 84 | 100 | 100 | 100 | 100 | 100 |
| Black water - gallons | 64 | 78 | 78 | 78 | 78 | 78 |

s = standard | o = option | n = not available | ♦ = not available in mid-door models | • = not available in front-door models
 * = not an option w/Residential Refrigerator option | † = required w/Residential Refrigerator option

* The maximum allowable combined weight of the coach with the attached towed vehicle. Towing and braking capacities may differ.
 GCWR assumes both vehicles have functioning brakes.

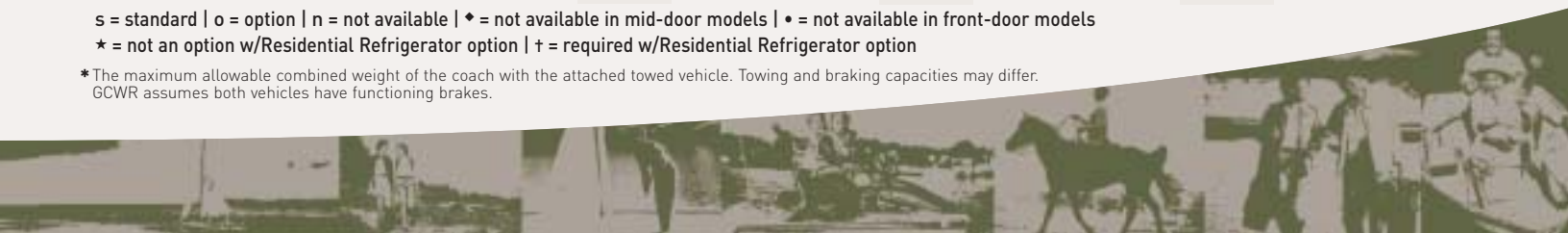

Alpine Coach FLOOR PLANS

40FDTs

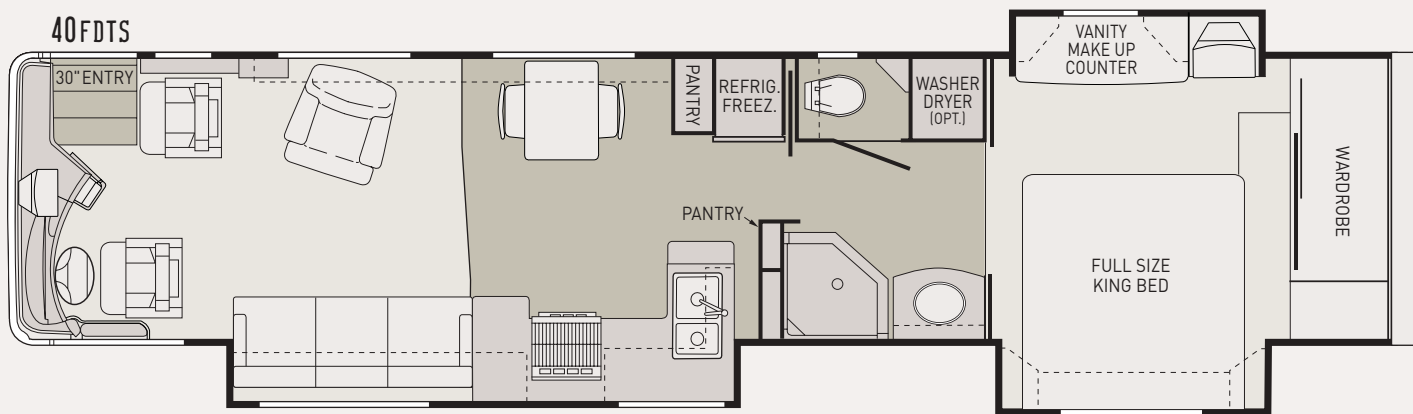

40MDTs

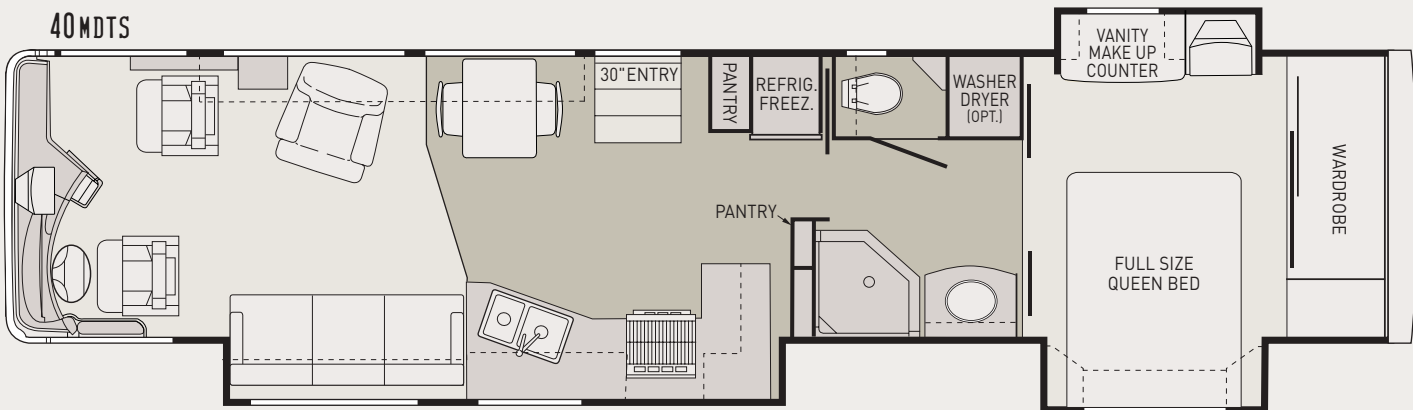

38FDDs

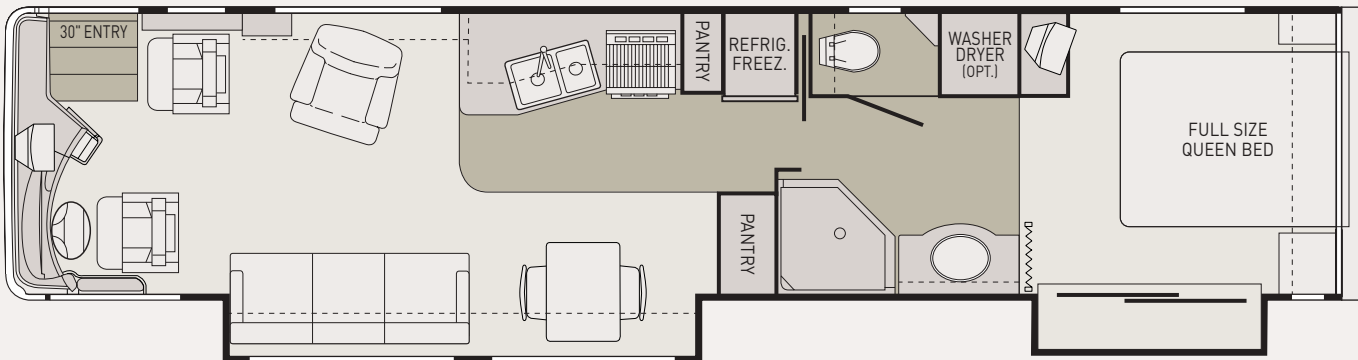

36FDDs

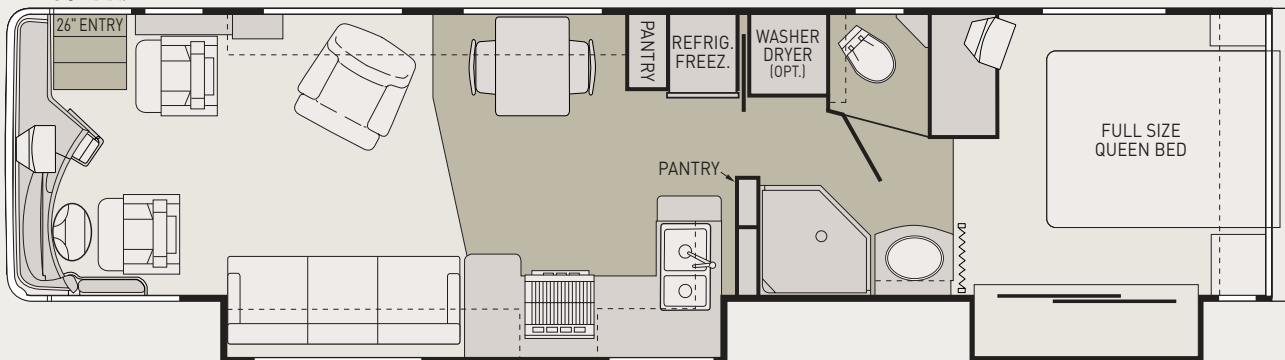

2003



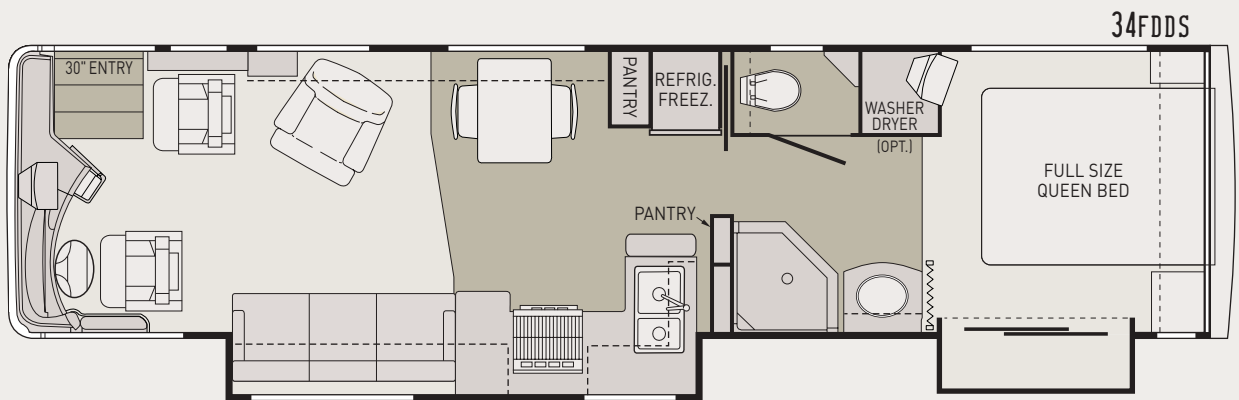
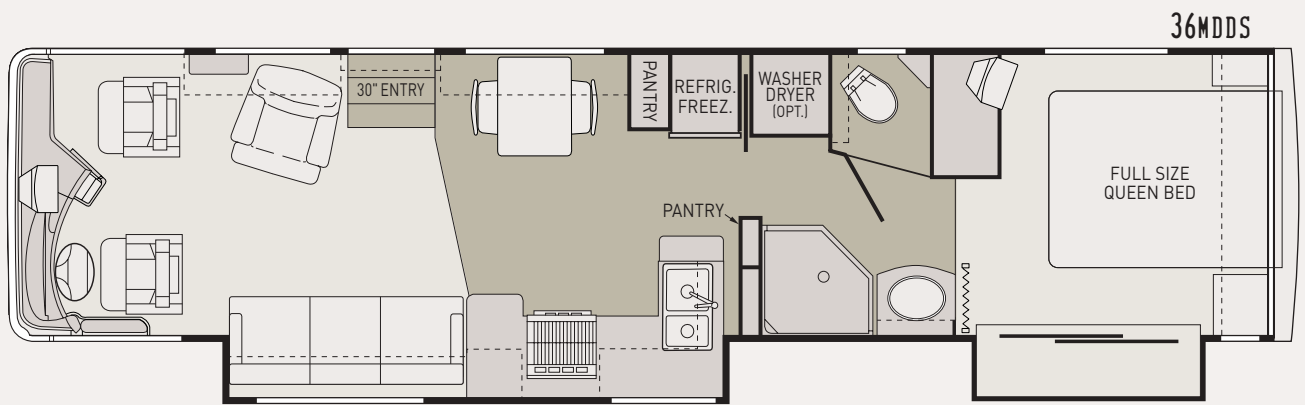

Alpine Coach FLOOR PLAN OPTIONS

CURBSIDE EZ BED

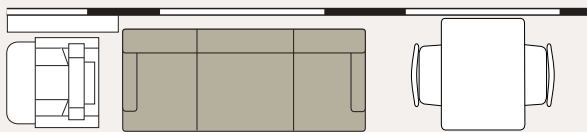

Available: 36FDDS, 38FDDS, 40FDTs

EURO CHAIR WITH OTTOMAN

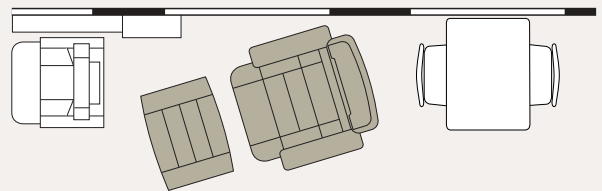

Available: all models

COMPUTER DESK WITH RECLINER

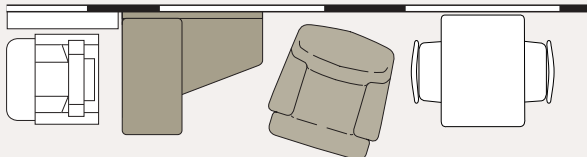

Available: 36FDDS, 40FDTs

BOOTH DINETTE

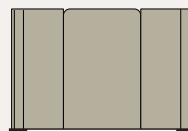

Available: 34FDDS, 36FDDS, 38FDDS, 40FDTs

GARDEN TUB/SHOWER

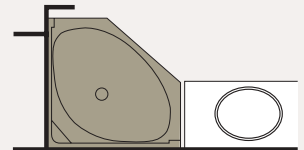

Available: all models

Every effort has been made to use accurate photographs, product descriptions and specifications at the time of printing. However, because of continuous and progressive product improvement, specifications and descriptions, including weights and measures, are subject to change without notice or obligation.

INSIDE OR OUT, IT'S THE PLACE TO BE!

MODEL 40 MDTs • Sage Point Interior with Solid Cherry Cabinetry, Ceramic Tile, Atwood® 22" Gas Oven, Flexsteel® Ultra-Leather Recliner and 21.5 cu. ft. Amana® Residential Refrigerator options.



Western Recreational Vehicles, Inc. is proud to introduce the new generation of Motor Coaches, the 2003 Alpine Coach – America's Premium Recreational Vehicle. We're passing on our tradition of first-class quality, comfort and convenience in every Alpine Coach.

Alpine Coach



EXTRA CARE AND ATTENTION



2003



MODEL 40 WDTS • Arctic Blue Premium Exterior with Winegard® Satellite Dish and Cummins® 8.9 ISL Electronic 400hp Engine options.

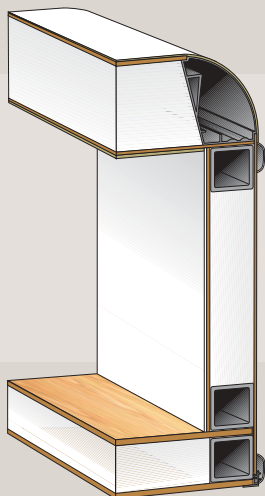

Alpine Coach CONSTRUCTION

Fully laminated vacuum bonded 6005 T5 aluminum tube construction with block foam insulation for comfort in any climate. The one-piece fiberglass roof is strong, durable and 5.25" thick to insulate from the sun. Sidewalls are 2" thick while the floor is 2.25" to create a quiet ride.

TO DETAIL.

ENJOY THE RIDE!

MODEL 40 MDTs • Meadow Green Premium Exterior with A&E One Step® Power Awning and Cummins® 8.9 ISL Electronic 400hp Engine options.



MAKE PLANS TO TAKE THE *Alpine Coach* TOUR

We invite you to visit our state-of-the-art manufacturing facility located in beautiful Yakima, Washington. During your extensive tour, you will see Alpine Coaches being assembled with tremendous skill and pride. You'll also see our stringent Quality Assurance Program at work. Tours are available Tuesday and Thursday at 10:00 am.

Your Authorized Dealer

Alpine Coach

Manufactured by Western Recreational Vehicles, Inc.
PO Box 9547, 3401 W. Washington Ave. • Yakima, WA 98909
Toll Free Product Information - (800) 777-4133 • www.wrv.com